



Natchez City Cemetery

OVER 490 CREPE MYRTLES

2 CEMETERY ROAD
NATCHEZ, MS



In 2005 the Adams County Master Gardeners began maintaining the crepe myrtles in the Natchez City Cemetery. As a project to prepare for a Master Gardener conference that was to occur in Natchez in 2012, the chart was prepared by local Master Gardeners. Their objective was to identify the beautiful colors of all the crepe myrtles there.

This feat was accomplished in 2011 by two Adams County Master Gardeners. They painstakingly travelled throughout each section of the cemetery during the summer blooming season, carefully notating what they found. A recent project was to spruce up the trees in the Browns Addition. They are beautiful.

AN ALLÉE OF BLOOMS!

Scan to find more
self-guided tour maps:



"WEYMOUTH HALL"
CIRCA 1855

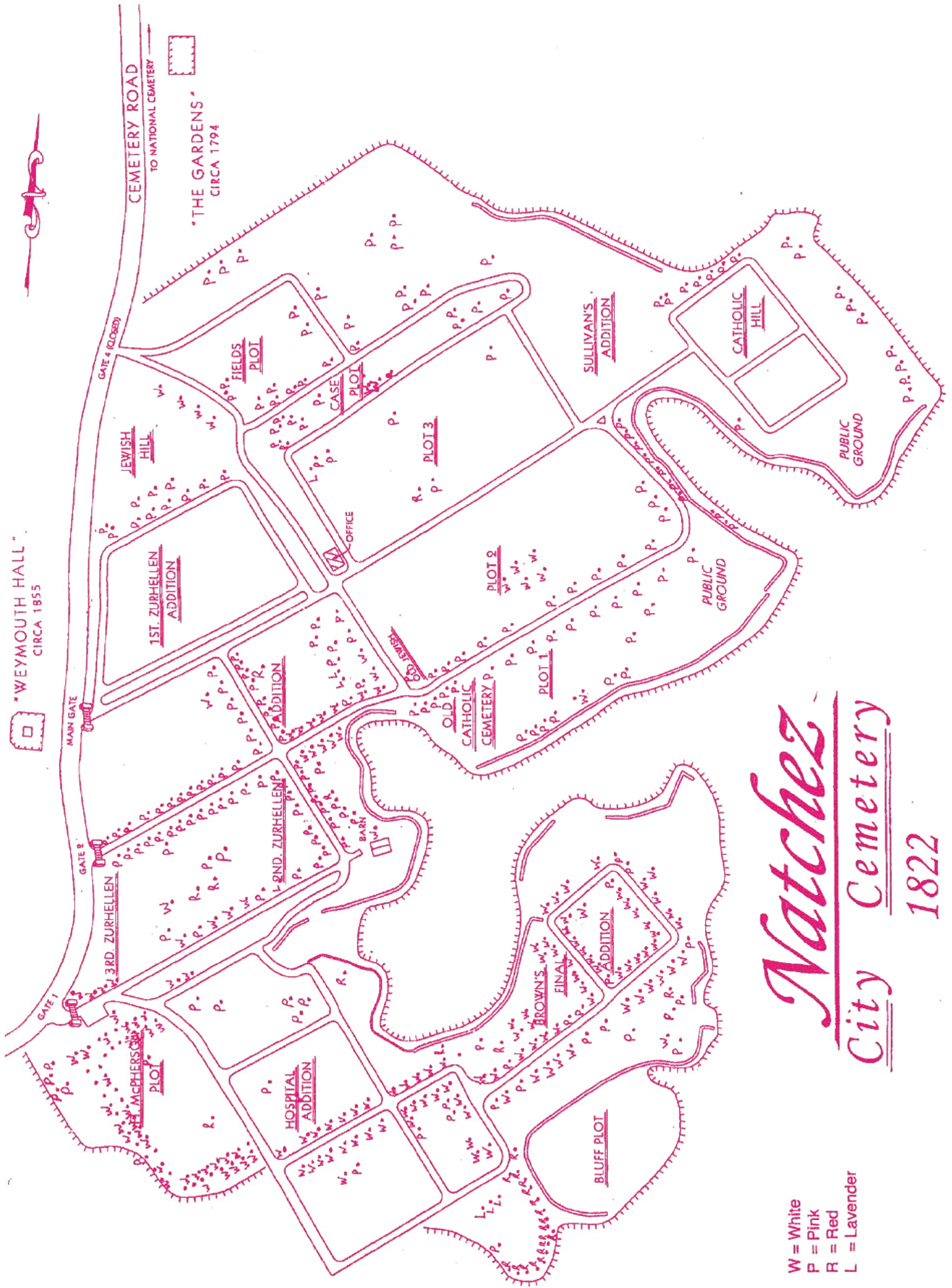

Natchez City Cemetery

1822

W = White
P = Pink
R = Red
L = Lavender